

**Suite Type B**  
**3 bedroom**  
**2 bathroom**  
**1640 SF net**

\*layout and measurements are based on original renderings and are not exactly as shown

## Carrying Costs (Sample from 2026)

Building & Property .....	\$964.77
Property Tax.....	402.55
Gas.....	40.66
Hydro.....	87.30
Cable TV .....	40.91
<b>Total Monthly Cost</b>	<b>\$1536.21</b>

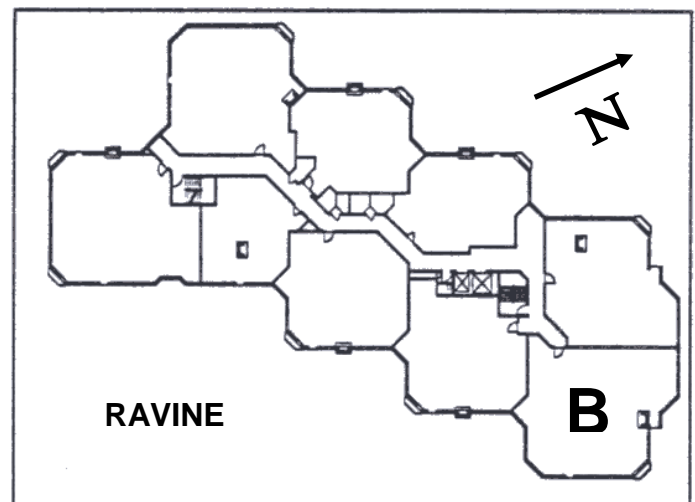

# **St. Joseph's Estates**

160 Ogilvie Street, Suite 608  
Dundas Ontario L9H 7M7

**Selling Price: \$790,000**

From its many windows, this 1640 square foot suite boasts an impressive view of the Estates ravine and the Dundas community. The low monthly carrying fee of \$1536.<sup>21</sup> includes taxes, heat, central air conditioning, hydro, cable, water, and building maintenance. Cogeco unlimited high-speed internet available for an additional \$31.19. You will appreciate the friendly and mature community living of St. Joseph's Estates in a safe, secure and accessible environment.

## **Suite Boasts**

Floor to ceiling windows  
Cultured marble windowsills  
Furnace with individually controlled heat/cool  
Upgraded water shut-off valves  
Hardwood throughout

## **Entrance Foyer**

Double closet with cedar and interior light  
Safety switch for living room lamp outlet

## **Open Concept:**

### **Living/Sunroom/Dining Room**

Floor to Ceiling Windows  
Cultured Marble Windowsills  
Window Coverings  
Sliding patio doors to Juliet balcony  
Cable jack and telephone outlet

## **Primary Bedroom**

Pocket door to kitchen  
Cable Outlet and Telephone Jack  
2 double closets with interior lights  
Closet organizer

## **Ensuite**

Cultured marble vanity top on neutral oak cabinetry  
Walk-in shower  
Large built-in storage cabinet.  
New toilet

## **Guest Bedrooms (1 & 2)**

Double Door Closet with Light  
Telephone Jack and Cable Outlet

## **Guest Bath**

Cultured marble vanity top on neutral oak cabinetry  
Tub/shower combination.

## **Laundry Room**

Bright and spacious  
Laundry sink  
Maytag side-by-side Washer and Dryer  
Storage shelves

## **Eat – In Kitchen**

Kitchen relocated from original floor plan to Studio location to showcase beautiful ravine views  
Natural oak kitchen cabinets customized by Paris Kitchens with ceramic backsplash.  
Under cupboard lighting, microwave shelf and roll out shelves.  
Tiffany light  
Maytag Self-cleaning oven,  
Samsung built-in dishwasher,  
Samsung Refrigerator,

## **Parking**

Keyless Remote Entry and Security Cameras  
Indoor Parking # 13  
Indoor Car Wash Bay, Golf Club Room & Bicycle storage  
On Floor Storage Locker (1<sup>st</sup> on right)

## **Common Amenities**

Party Room with Kitchenette  
Furnished Lobby  
Secure Entry with Power Assisted Doors  
Closed Circuit Entrance Security Camera  
Onsite Postal Pickup and Delivery  
Easy Walking Distance to all Local Amenities  
Church Services, Recreation and Health  
Services available at St. Josephs Villa