

# St. Joseph's Estates

150 Ogilvie Street, Suite 505

Dundas Ontario L9H 7B9

**Asking Price: \$515,000**

This suite boasts a spectacular view of the ravine behind St. Joseph's Estates and the Desjardins Canal in Dundas. The low monthly maintenance fee of \$939.<sup>57</sup> includes taxes, heat, central air conditioning, hydro, cable, water and building maintenance. Cogeco internet service is available for an additional \$32. You will appreciate the friendly and mature community living of St. Joseph's Estates in a safe, secure and accessible environment.

## Entrance Foyer

Double Closet with Interior Light  
Safety Switch for Living Room Lamp Outlet  
*Engineered Hardwood at Entry, Dining Room, Kitchen, Bathroom*  
*Carpeting(2010) in Living Room, Sunroom and Bedroom*

## Dining Room

Open Concept to Living Room  
Chandelier

## Living Room

Electric Fireplace  
Floor to ceiling windows  
Vertical Blinds on Windows  
Cultured Marble Windowsills  
Cable Outlet and Telephone Jack

## Sunroom

Floor to Ceiling Windows  
Open Concept to Living Room  
Double French Doors to Master Bedroom  
Vertical Blinds on Windows  
Cultured Marble Windowsills  
Cable Outlet

## Master Bedroom

Double French Doors to Sunroom  
Double Closet with Interior Lights and Mirrored Sliding Doors  
Cable Outlet and Telephone Jack

## Laundry Room

Inglis Side-by-Side Washer and Dryer  
Extra storage shelving  
Upgraded Water Shut-off Valves

Additional Closet between Bath and Bedroom with mirrored sliding door not on floor plan

## Ensuite Bath

White Cabinetry with Cultured Marble Vanity  
Medicine Cabinet  
Light fixture (2010)  
Step in Shower with Grab Bars (Silicone replaced 2024)  
Elongated and Raised Lavatory

## Kitchen

Customized Open Kitchen Layout  
Cognac Oak Kitchen Cabinets by Paris Kitchens  
Panasonic Microwave Shelf and Outlet  
Ceramic Backsplash and Pull-out Shelving  
Maytag Smooth Top Self-Cleaning Stove/Range  
Samsung Refrigerator (2022) and Bosch Dishwasher (2024)  
Custom Under-Cupboard Task Lighting  
Telephone Jack

## Parking

Surface Parking Space # 6  
Indoor Car Wash Bay  
Golf Cart & Bicycle Room  
Storage Locker at Parking Level (5<sup>th</sup> on left)

## Common Amenities

Party Room with Kitchenette  
Furnished Lobby  
Secure Entry with Power Assisted Doors  
Closed Circuit Entrance Security Camera  
Community Garden  
Onsite Postal Pickup and Delivery  
Easy Walking Distance to all Local Amenities  
Church Services, Recreation and Health Services available at St. Josephs Villa

# St. Joseph's Estates

DUNDAS ONTARIO

Beth Etherington  
 (905) 627-3541 extension 2222  
[www.sjv.on.ca](http://www.sjv.on.ca) - Life Equity Housing  
 Email: betherington@sjv.on.ca

**Suite Type G**  
 1 bedroom  
 1 bathroom,  
 860 SF net

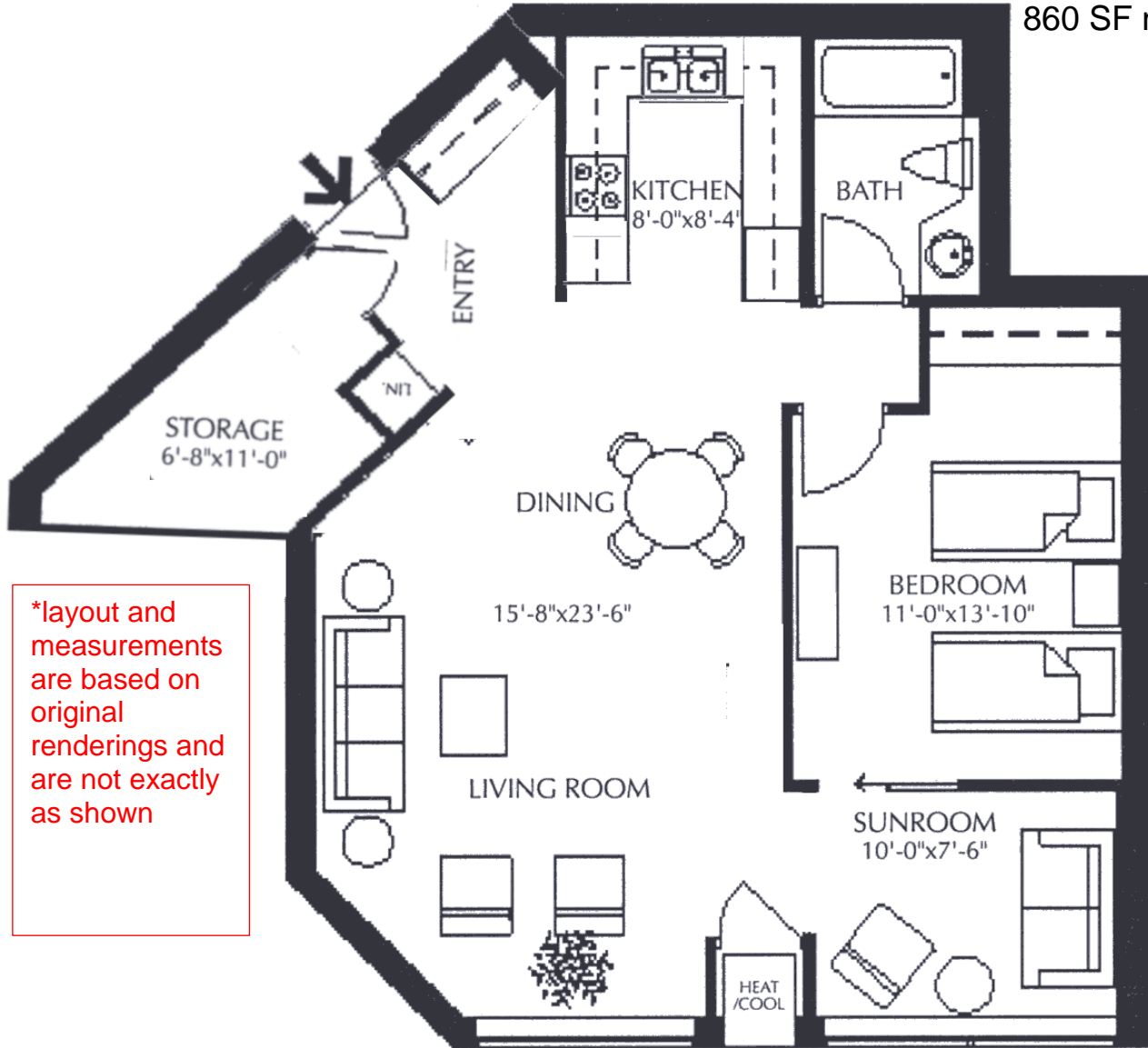

\*layout and measurements are based on original renderings and are not exactly as shown

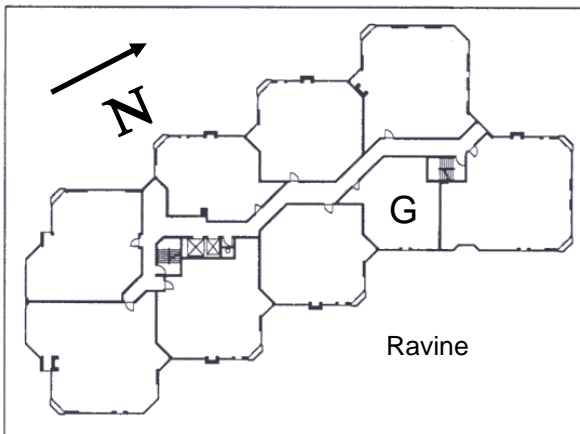

### Carrying Costs (Sample from 2025)

Building & Property .....	\$600.37
Property Tax.....	204.98
Gas.....	30.52
Hydro.....	63.52
Cable TV .....	40.18
<b>Total Monthly Cost</b>	<b>\$ 939.57</b>