

St. Joseph's Estates

150 Ogilvie Street, Suite 503

Dundas Ontario L9H 7B9

Selling Price: \$760,000

This suite boasts a beautiful view of the Dundas escarpment. It has been meticulously cared for by the original owner. The low monthly maintenance fee of \$1294.³⁷ includes taxes, heat, central air conditioning, hydro, basic cable, water and building maintenance. You will appreciate the friendly and mature community living of St. Joseph's Estates in a safe, secure and accessible environment.

Suite Boasts

Floor to ceiling windows with beautiful views and cultured marble windowsills
Neutral tone window treatments
Furnace with individually controlled heat/cool
Natural Red Oak Hardwood Flooring in LR, DR, SR, Kitchen, and Entry

Entrance Foyer

Closet with interior light
Safety switch for living room lamp outlet

Living Room

Bright open concept through to Dining room and sunroom

Dining Room

Dining room chandelier with dimmer switch

Master Bedroom

Walk-in closet with shelving and clothes bar
Cable outlet and telephone jack
Peerless Performa Cinnamon Pink Carpeting

Ensuite Bath

Large window brings in natural lighting
One-piece tub/shower combination
Cultured marble vanity on oak cabinetry
vinyl flooring

Guest Bedroom

Large double sized closet with light
Cable outlet and telephone jack
Peerless Performa Cinnamon Pink Carpeting

Guest Bath

One-piece tub/shower combination
Cultured marble vanity on oak cabinetry
Vinyl flooring

Laundry Room

Includes full-size laundry tub
Side-by-side Kenmore washer and dryer
Laundry room is extra large because it has the storage locker space built into the laundry room space
Telephone jack
Vinyl flooring

Sunroom/Den

Bright open space
Juliet balcony with sliding patio door
2 Cable outlets

Kitchen

Bright eat-in kitchen with floor to ceiling window
Custom cabinetry by Paris Kitchens with under-cupboard counter lighting, pull-out shelving, pot drawers, pantry, and desk area
Double stainless-steel sink, Kenmore Refrigerator, built-in dishwasher, electric range
Microwave shelf and Telephone jack

Parking

Keyless Remote Entry and Security Cameras
Indoor Parking #16
Indoor Car Wash Bay, Golf Cart and Bike Rooms

Common Amenities

Party Room with Kitchenette
Furnished Lobby
Secure Entry with Power Assisted Doors
Closed Circuit Entrance Security Camera
Community Garden
Onsite Postal Pickup and Delivery
Easy Walking Distance to all Local Amenities
Church Services, Recreation and Health
Services available at St. Josephs Villa

St. Joseph's Estates

DUNDAS ONTARIO

Beth Etherington
 (905) 627-3541 extension 2222
 Email: betherington@sjv.on.ca
www.sjv.on.ca - Life Equity Housing



Suite Type E
 2 bedroom
 2 bathroom,
 1450 SF net

*layout and measurements are based on original renderings and may not be exactly as shown

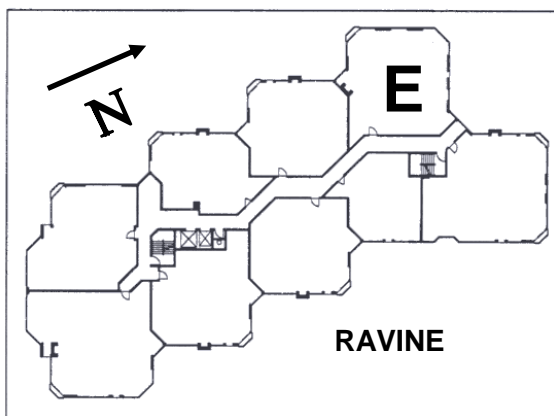

Carrying Costs (Sample from 2024)

Building & Property	\$ 806.71
Property Tax.....	335.13
Gas.....	40.10
Hydro.....	71.52
Cable TV	40.91
Total Monthly Cost	\$ 1294.37