

# St. Joseph's Estates

160 Ogilvie Street, Suite 309

Dundas Ontario L9H 7M7

Selling Price: \$670,000

This suite boasts a spectacular panoramic view of the Town of Dundas, the Niagara escarpment and Spencer Creek Ravine. The low monthly maintenance fee of \$1148.<sup>16</sup> includes taxes, heat, central air conditioning, hydro, cable and building maintenance. You will appreciate the friendly and mature community living of St. Joseph's Estates in a safe, secure and accessible environment.

## Entrance Foyer

Custom Halogen Pot Lights  
Closet with Interior Light  
Safety Switch for Living Room Lamp Outlet  
Wall to Wall, Ivory Wool Carpeting  
throughout Living Room, Dining Room,  
Bedroom & Sunroom

## Living Room

Gas Fireplace with Marble Surround  
Floor to Ceiling Windows  
Neutral Roll Blinds  
Cultured Marble Windowsills  
Cable Access

## Dining Room

Dining Room Light Fixture  
Switched Den/Sunroom Lamp Outlet

## Primary Bedroom

Floor to Ceiling Windows  
Cultured Marble Windowsills  
Neutral Roll Blinds  
Cable and Telephone Jacks  
Two Double Closets with Interior Lights

## Ensuite Bath

Lever Handled Faucets  
Neutral Maple Cabinetry with  
Cultured Marble One-Piece Vanity  
48-inch Walk-in Shower with Built in Seat  
Generous Size Linen Closet

## Guest Bath

Lever Handled Faucets  
Shower/Tub Combination  
Neutral Maple Cabinetry with  
Cultured Marble One-Piece Vanity

## Laundry Room

Large Capacity Frigidaire Washer & Dryer  
White 2 glass door cabinet  
Telephone Jack

## Sunroom / Bedroom 2 / Den

French Doors  
Juliet Balcony  
Floor to Ceiling Windows  
Cultured Marble Windowsills  
Neutral Roll Blinds  
Cable and Telephone Jacks

## Kitchen

Custom Pearl Maple Cabinetry by Paris Kitchens  
Custom Under-Cupboard Counter Lighting  
Halogen Pot Lights over Sink  
Kitchen Open to Living Room  
Kenmore Dishwasher  
Kenmore Refrigerator  
Frigidaire Electric Range  
Telephone Jack

## Storage Room

Generous Size  
Electrical Outlet  
Secure Private Entry

## Parking

Keyless Remote Entry and Security Cameras  
Underground Parking #33 Steps to Elevator  
Indoor Car Wash Bay

## Common Amenities

Party Room with Kitchenette  
Furnished Lobby  
Secure Entry with Power Assisted Doors  
Closed Circuit Entrance Security Camera  
Community Garden  
Onsite Postal Pickup and Delivery  
Easy Walking Distance to all Local Amenities  
Church Services, Recreation and Health  
Services available at St. Josephs Villa

# St. Joseph's Estates

DUNDAS ONTARIO

Beth Etherington  
 (905) 627-3541 extension 2222  
[www.sjv.on.ca](http://www.sjv.on.ca) - Life Equity Housing

Suite Type **M**  
 2 bedroom  
 2 bathroom,  
 1225 SF net

\*layout and measurements are based on original renderings and may not be exactly as shown

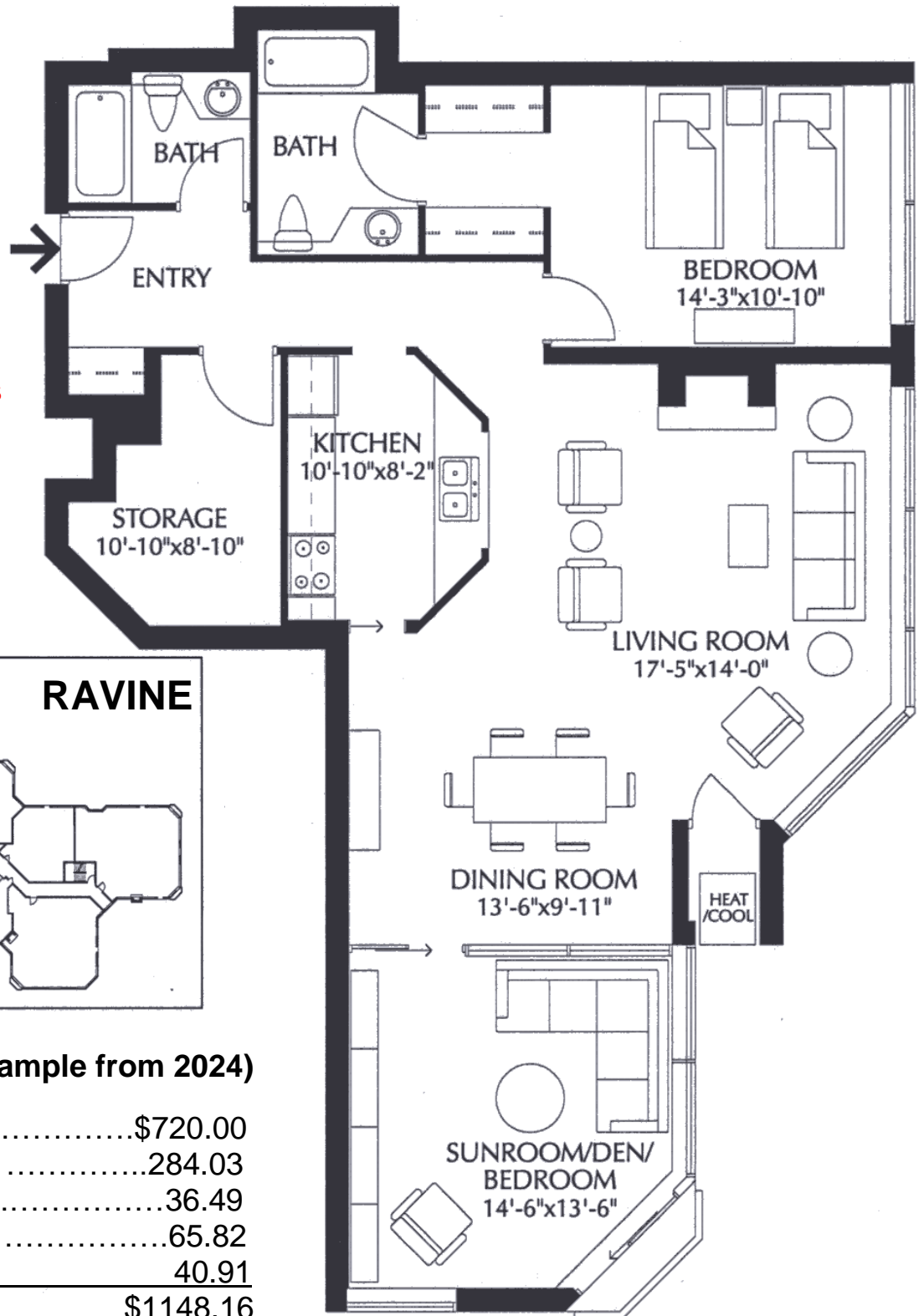

### Carrying Costs (Sample from 2024)

Building & Property .....	\$720.00
Property Tax.....	284.03
Gas.....	36.49
Hydro.....	65.82
Cable TV .....	40.91
<b>Total Monthly Cost</b>	<b>\$1148.16</b>